



PCM

£1,350

****AVAILABLE EARLY MARCH****

A spacious two bedroom house that has been well looked after and is presented in great condition throughout. Internally the sizable family home comprises; entrance hall, modern fitted kitchen, open plan lounge/dining room, two bedrooms and modern bathroom. The property also benefits from; well-maintained gardens, UPVC double glazing and gas central heating.

HOLDING FEE: £311.53

DEPOSIT REQUIRED: £1,557.69

LENGTH OF TENANCY: 12 MONTHS

- AVAILABLE MARCH
- MODERN FITTED KITCHEN
- MODERN BATHROOM
- CLOSE TO AMENITIES
- UNFURNISHED
- LARGE LOUNGE/DINER
- TWO BEDROOMS
- FRONT & REAR GARDENS
- UPVC DOUBLE GLAZING
- GAS CENTRAL HEATING



132 Fowler Road, Aylesbury, Buckinghamshire, HP19 7QJ

Estate Agents ~ Lettings Agents ~ Valuers ~ Independent Mortgage Advisors

Total Approx. Floor Area 883 Sq.ft / 82 sq.m

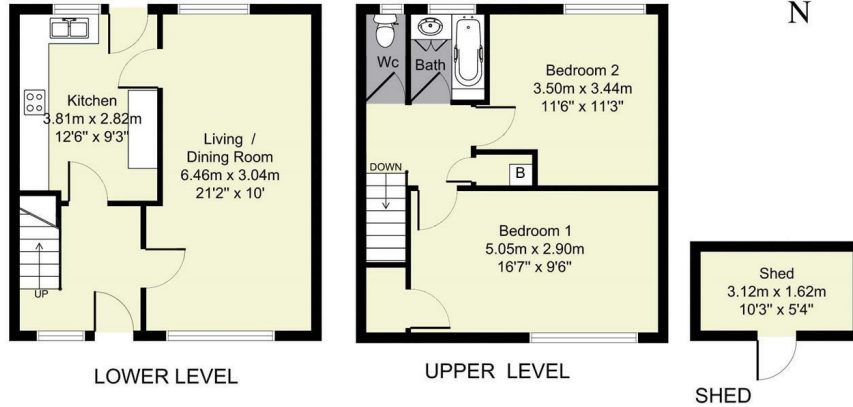

All measurements of walls, doors, windows, fittings and appliances, including their size and location, are shown as standard sizes and therefore cannot be regarded as a representation by the seller.

